



MADE IN BRITAIN



476

Adaptors and Reducers

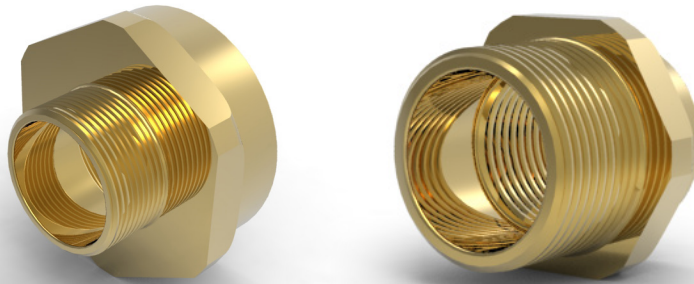

Metallic Adaptor and Reducer Range; designed to increase or reduce entry thread sizes when mounted to an enclosure. Suitable for use in Flameproof and Increased Safety protection concepts along with mining applications

Technical Data

| | |
|------------------------|---|
| Ingress Protection | IP66* |
| Operating Temperature | -60°C to +200°C** |
| Construction Materials | Manufactured in Brass (Standard), Nickel Plated Brass or 316L Stainless Steel |
| Threadform | M16 to M130** 3/8" NPT to 6" NPT |

*In order to maintain IP rating at the joints a suitable sealing method must be used.
**With No IP Seal fitted
**For M16-M75: Metric Thread Length 15mm as standard; Metric Thread Pitch 1.5mm as standard
For M80-M130: Metric Thread Length 20mm as standard; Metric Thread Pitch 2mm as standard

Approvals

| | |
|-------------------------------|--|
| Applications | Suitable for Use in Zone 1, Zone 21, Zone 2, Zone 22 and mining applications |
| Protection Class | Ex II 2GD Ex db eb IIC Gb; Ex tb IIIC Db Ex I M2 Ex db eb I Mb |
| Construction & Test Standards | IEC/EN 60079-0, IEC/EN 60079-1, IEC/EN 60079-7 and IEC/EN 60079-31 |
| ATEX Certificate No | Baseefa 11ATEX0067X |
| UKEx Certificate No | BAS21UKEX0057X |
| IECEx Certificate Number | IECEx BAS11.0037X |
| Marine Approvals | ABS: 17-LD1653734-PDA BV: 43523/B0 |
| Additional Certifications | CCC: 2020312313000308 EN EAC: No EA3C RU C-GB.HA91.B.00265/21 EQM: 20-11-27224/Q20-11-000979/NB0007 Inmetro: IEx 15.0193X SONCAP: LCOGB049552-0500 |

NEC/CEC

| | |
|-------------------------------|--|
| NEC Protection Class | CI ABCD CII EFG CIII: CI Zn1 AEx d e IIC Gb; Zn 21 AEx tb IIIC Db |
| CEC Protection Class | Ex db eb IIC Gb; Zn 21 Ex tb IIIC Db |
| c CSA us Certificate | 1731876 |
| Construction & Test Standards | CSA C22.2 No. 25-1966, 30-M1986, 45-M1981, 94-M91, 18.3.-12 CSA/UL 60079-0, CSA/UL 60079-1, CSA/UL 60079-7, CSA/UL 60079-31, UL514B |

Ordering Information

| Product | Male Thread Size | Female Thread Size | Material | Finish |
|---------|------------------|--------------------|----------|--------|
| 476 | M40 | M32 | Brass | NP |

476 Allowable Thread Combinations

| KEY: A = Adaptor R = Reducer | | Female Thread | | | | | | | | | | | | | | | | Metric | |
|------------------------------------|----------------|---------------|-------------|-------------|-----------|---------------|---------------|-----------|---------------|-----|-----------|----------------|------|------------|------|------|----|--------|-----|
| | | M16 3/8" | M20 1/2" | M25 3/4" | M32 1" | M40 1 1/4" | M50 1 1/2" | M63 2" | M75 2 1/2" | M80 | M90 3" | M100 3 1/2" | M110 | M115 4" | M120 | M130 | 5" | 6" | NPT |
| Male Thread | M16 3/8" | A | A | A | | | | | | | | | | | | | | | |
| | M20 1/2" | R | A | A | A | | | | | | | | | | | | | | |
| | M25 3/4" | R | R | A | A | A | | | | | | | | | | | | | |
| | M32 1" | R | R | R | A | A | A | | | | | | | | | | | | |
| | M40 1 1/4" | R | R | R | R | A | A | A | | | | | | | | | | | |
| | M50 1 1/2" | R | R | R | R | R | A | A | A | | | | | | | | | | |
| | M63 2" | R | R | R | R | R | R | A | A | A | | | | | | | | | |
| | M75 2 1/2" | R | R | R | R | R | R | R | A | A | A | | | | | | | | |
| | M80 | R | R | R | R | R | R | R | R | A | A | A | | | | | | | |
| | M90 3" | R | R | R | R | R | R | R | R | R | R | A | A | A | | | | | |
| | M100 3 1/2" | R | R | R | R | R | R | R | R | R | R | R | A | A | A | | | | |
| | M110 | R | R | R | R | R | R | R | R | R | R | R | R | A | A | A | | | |
| | M115 4" | R | R | R | R | R | R | R | R | R | R | R | R | R | A | A | A | | |
| | M120 | R | R | R | R | R | R | R | R | R | R | R | R | R | R | A | A | | |
| | M130 | R | R | R | R | R | R | R | R | R | R | R | R | R | R | R | A | | |
| | | 5" | R | R | R | R | R | R | R | R | R | R | R | R | R | R | R | A | |
| | | 6" | R | R | R | R | R | R | R | R | R | R | R | R | R | R | R | R | A |
| Metric | NPT | | | | | | | | | | | | | | | | | | |